

**BEFORE THE ILLINOIS POLLUTION CONTROL BOARD**

Lean Pork Producers, LLC – Stronghurst )  
(Property Identification Number ) PCB 15-  
08-003-004-00 ) (Tax Certification)  
)  
)

**NOTICE**

Steve Santarelli  
Illinois Department of Revenue  
101 West Jefferson  
Post Office Box 19033  
Springfield, Illinois 62794

John Theirrault, Clerk  
Illinois Pollution Control Board  
James R. Thompson Center  
100 West Randolph Street, Suite 11-500  
Chicago, Illinois 60601

Peter Rousonelos  
P.O. Box 211  
Stronghurst, Illinois 61480

**PLEASE TAKE NOTICE** that I have today filed with the Office of the Clerk of the Pollution Control Board an **APPEARANCE AND THE RECOMMENDATION OF THE ILLINOIS ENVIRONMENTAL PROTECTION AGENCY**, a copy of which is herewith served upon you.

ILLINOIS ENVIRONMENTAL PROTECTION AGENCY

By:   
Joey Logan-Pugh  
Assistant Counsel  
Division of Legal Counsel

DATED: September 11, 2015

Illinois Environmental Protection Agency  
1021 North Grand Avenue East  
Post Office Box 19276  
Springfield, Illinois 62794-9276  
(217) 782-5544

**THIS FILING IS SUBMITTED ON RECYCLED PAPER**

**BEFORE THE ILLINOIS POLLUTION CONTROL BOARD**

Lean Pork Producers, LLC - Stronghurst )  
(Property Identification Number ) PCB 15-  
08-003-004-00) (Tax Certification)  
)

**A P P E A R A N C E**

The undersigned, as one of its attorneys, hereby enters an APPEARANCE on behalf of Respondent,  
Illinois Environmental Protection Agency.

ILLINOIS ENVIRONMENTAL PROTECTION AGENCY

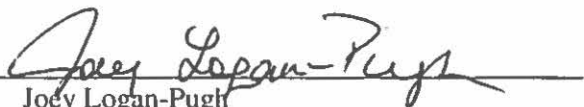
By:   
Joey Logan-Pugh  
Assistant Counsel  
Division of Legal Counsel

DATED: September 11, 2015

Illinois Environmental Protection Agency  
1021 North Grand Avenue East  
Post Office Box 19276  
Springfield, Illinois 62794-9276  
(217)782-5544

**THIS FILING IS SUBMITTED ON RECYCLED PAPER**

**BEFORE THE ILLINOIS POLLUTION CONTROL BOARD**

**Lean Pork Producers, LLC – Stronghurst** )  
**(Property Identification Number** ) **PCB 15-**  
**08-003-004-00)** ) **(Tax Certification)**  
 )  
 )

**RECOMMENDATION OF THE ILLINOIS ENVIRONMENTAL PROTECTION AGENCY**

The Illinois Environmental Protection Agency (“Illinois EPA”) hereby files its Recommendation pursuant to Section 125.204 of the regulations of the Illinois Pollution Control Board (“Board”), 35 Ill. Adm. Code 125.204.

1. On January 27, 2015, the Illinois EPA received a request from Lean Pork Producers, LLC (log number TC-03-15, Exhibit A) for an Illinois EPA recommendation regarding the tax certification of water pollution control facilities pursuant to 35 Ill. Adm. Code 125.204.

2. The facility’s address is: Lean Pork Producers, LLC  
1150 North Road  
P. O. Box 211  
Stronghurst, Illinois 61480

The following proposed water pollution control facilities in this request are located at Section 3, T9N, R5W of the 4th P.M. in Henderson County, at the above street address and consist of the following:

Livestock waste management facilities consisting of a concrete manure pit (approximately 281.33 ft. x 71.17 ft. x 8 ft.) with a slotted floor over the pit, and four concrete pump outs for each pit (6 ft. x 6 ft. x 8 ft. each). (Property ID #08-012-008-00)

These livestock waste management facilities are used to collect, transport and/or store livestock wastes prior to cropland application, and are further described in Exhibit A.

4. Section 11-10 of the Property Tax Code, 35 ILCS 200/11-10 (2014), and Section 125.200(a) of the Board's regulations, 35 Ill. Adm. Code 125.200(a), define

"pollution control facilities" as:

any system, method, construction, device or appliance appurtenant thereto or any portion of any building or equipment, that is designed, constructed, installed or operated for the primary purpose of: (a) eliminating, preventing, or reducing air or water pollution ...or (b) treating, pretreating, modifying or disposing of any potential solid, liquid or gaseous pollutant which if released without treatment, pretreatment modification or disposal might be harmful, detrimental or offensive to human, plant or animal life, or to property.

5. In order to receive preferential treatment in accordance with 35 ILCS 200/11-5, pollution control facilities must be certified as such by the Board, 35 ILCS 200/11-20 (2014) and 35 Ill. Adm. Code 125.200(a).
6. Upon receipt of a tax certification application, the Illinois EPA must file a recommendation regarding the application with the Board, in accordance with 35 Ill. Adm. Code 125.205(a).
7. Based on the information in the application and the purpose of the facilities, it is the Illinois EPA's engineering judgment that the described facilities may be considered "pollution control facilities," pursuant to 35 Ill. Adm. Code 125.200(a), with the primary purpose of eliminating, preventing, or reducing water pollution, or as otherwise provided in 35 Ill. Adm. Code 125.200, and are eligible for tax certification from the Board.

WHEREFORE, the Illinois EPA recommends that the Board issue the requested tax certification.

ILLINOIS ENVIRONMENTAL PROTECTION AGENCY

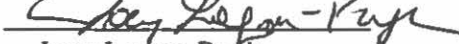
By:   
Joey Logan-Pugh  
Assistant Counsel  
Division of Legal Counsel

Dated: September 11, 2015  
Illinois Environmental Protection Agency  
1021 North Grand Ave. E.  
P.O. Box 19276  
Springfield, Illinois 62794-9276  
217/782-5544



## ILLINOIS ENVIRONMENTAL PROTECTION AGENCY

1021 NORTH GRAND AVENUE EAST, P.O. BOX 19276, SPRINGFIELD, ILLINOIS 62794-9276 • (217) 782-2829

BRUCE RAUNER, GOVERNOR

LISA BONNETT, DIRECTOR

# Memorandum

To: Charles Gunnarson, Division of Legal Counsel

From: Al Keller, Manager, Permit Section *AK*

Date:

Re: Lean Pork Producer, LLC  
PO Box 211  
Stronghurst, IL 61480  
Recommendation of Tax Certification  
Log # TC-03-15  
Property ID #'s 08-012-008-00 & 08-003-004-00

The Bureau of Water received a request on January 27, 2015 from Lean Pork Producer, LLC for an Illinois EPA recommendation regarding the tax certification of water pollution control facilities pursuant to 35 Il. Adm. Code 125.204. We offer the following recommendation.

The water pollution control facilities in this request include the following:

Lean Pork Producer, LLC  
Gus P. Rousonelos  
Stronghurst, IL

Property ID # 08-012-008-00  
Section 12, T9N, R5W of the 4<sup>th</sup> PM in Henderson County

Livestock waste handling facilities consisting of a concrete manure pit (281.33 ft. x 71.17 ft. x 8 ft.), slotted floor over the pit that collects swine waste, and four (4) concrete pump outs (6 ft. x 6 ft. x 8 ft. each). These livestock waste management facilities are used to collect, transport, and/or store livestock waste prior to cropland application.

Property ID # 08-003-004-00  
Section 3, T9N, R5W of the 4<sup>th</sup> PM in Henderson County

Livestock waste handling facilities consisting of a concrete manure pit (281.33 ft. x 71.17 ft. x 8 ft.), slotted floor over the pit that collects swine waste, and four (4) concrete pump outs (6 ft. x 6 ft. x 8 ft. each). These livestock waste management facilities are used to collect, transport, and/or store livestock waste prior to cropland application.

These facilities are further described in the enclosed applications and supporting documents.

Page No. 2  
Log TC-03-15

Based on the information included in this submittal, it is our engineering judgment that the above proposed facilities may be considered "Pollution Control Facilities" under 35 IAC 125.200(a), with the primary purpose of eliminating, preventing, or reducing water pollution, or as otherwise provided in this section, and therefore eligible for tax certification from the Illinois Pollution Control Board. The Bureau of Water therefore recommends that the Board issue the requested tax certification for these facilities.

If you have any questions regarding the above, please contact Jenny Larsen at 217/782-0610.

SAK:JML:Tax Certs\Livestock\LogTC-03-15.docx

cc: Tax Cert File

APPLICATION FOR CERTIFICATION (PROPERTY TAX TREATMENT)  
 POLLUTION CONTROL FACILITY  
 AIR  WATER

ILLINOIS ENVIRONMENTAL PROTECTION AGENCY  
 P. O. Box 19276, Springfield, IL 62794-9276

This Agency is authorized to request this information under Illinois Revised Statutes, 1979, Chapter, 120, Section 502a-5. Disclosure of this information is voluntary. However, failure to comply could prevent your application from being processed or could result in denial of your application for certification.

FOR AGENCY USE			
File No.	Date Received	Certification No.	Date
Sec. A  APPLICANT	Company Name <i>Lean Pork Producer, LLC</i>		
	Person Authorized to Receive Certification <i>Gus P. Rousoneklos</i>		Person to Contact for Additional Details <i>Peter Rousoneklos</i>
	Street Address <i>25925 W. 135th St.</i>		Street Address <i>PO Box 211</i>
	Municipality, State & Zip Code <i>Plainfield, IL 60544</i>		Municipality, State & Zip Code <i>Stoughton, IL 61480</i>
	Telephone Number <i>815-715-6494</i>		Telephone Number <i>309-363-5358</i>
	Location of Facility Quarter Section Township Range <i>NE Quarter Sec 3 Twnshp 9 Range 5</i>		Municipality Township <i>Stoughton</i>
	Street Address		County Book Number <i>Henderson 550 page 001</i>
	Property Identification Number <i>08-003-004-00 /</i>		Parcel Number
Sec. B  MANUFACTURING OPERATIONS	Nature of Operations Conducted at the Above Location <i>Swine Production</i>		
	Water Pollution Control Construction Permit No.	Date Issued	
	NPDES PERMIT No.	Date Issued	Expiration Date
	Air Pollution Control Construction Permit No.	Date Issued	
	Air Pollution Control Operating Permit No.	Date Issued	
Sec. C  MANUFACTURING PROCESS	Describe Unit Process		
	Materials Used in Process		
Sec. D  POLLUTION CONTROL FACILITY DESCRIPTION	Describe Pollution Abatement Control Facility		
	<ul style="list-style-type: none"> <li>- Diagram Attached to Application</li> <li>- Dimension of Pit = 281'-4" x 71'-2" x 8' deep</li> <li>- Dimension of Pit Pump Outs = 6' x 6' x 8' deep (4 total)</li> <li>- All concrete construction</li> </ul>		

**RECEIVED**  
 JAN 27 2015  
 BOWMAN/PC/PERMIT SECTION



Sec. E	(1) Nature of Contaminants or Pollutants			
POLLUTION CONTROL FACILITY - CONTAMINANTS           ACCOUNTING DATA		Material Retained, Captured or Recovered		
	Contaminant or Pollutant	DESCRIPTION	DISPOSAL OR USE	
	Swine Manure	Swine Manure	Land Applied	
	(2) Point(s) of Waste Water Discharge			
	none			
			Plans and Specifications Attached	Yes <input type="checkbox"/> No <input type="checkbox"/>
	(3)	Are contaminants (or residues) collected by the control facility?		Yes <input type="checkbox"/> No <input type="checkbox"/>
	(4)	Date installation completed _____ status of installation on date of application <u>Complete</u>		
	(5)	a. FAIR CASH VALUE IF CONSIDERED REAL PROPERTY:	\$ <u>500,000</u>	
		b. NET SALVAGE VALUE IF CONSIDERED REAL PROPERTY:	\$	
	c. PRODUCTIVE GROSS ANNUAL INCOME OF CONTROL FACILITY:	\$		
	d. PRODUCTIVE NET ANNUAL INCOME OF CONTROL FACILITY:	\$		
	e. PERCENTAGE CONTROL FACILITY BEARS TO WHOLE FACILITY VALUE:	% <u>55%</u>		
Sec. F	The following information is submitted in accordance with the Illinois Property Tax Code, as amended, and to the best of my knowledge, is true and correct. The facilities claimed herein are "pollution control facilities" as defined in Section 11-10 of the Illinois Property Tax Code.			
SIGNATURE				
	Signature	Member Title		
Sec. G	INSTRUCTIONS FOR COMPILING AND FILING APPLICATION			
General: Separate applications must be completed for each control facility claimed. Do not mix types (water and air). Where both air and water operations are related, file two applications. If attachments are needed, record them consecutively on an index sheet.				
INSTRUCTIONS	Sec. A	Information refers to applicant as listed in the tax records and the person to be contacted for further details or for inspection of facilities. Define facility location by street address or legal description. A plat map location is required for facilities located outside of municipal boundaries. The property identification number is required.		
	Sec. B	Self-explanatory. Submit copies of all permits issued by local pollution control agencies. (e.g. MSD Construction Permit)		
	Sec. C	Refers to manufacturing processes or materials on which pollution control facility is used.		
	Sec. D	Narrative description of the pollution control facility, indicating that its primary purpose is to eliminate, prevent or reduce pollution. State the type of control facility. State permit number, date, and agency issuing permit. A narrative description and a process flow diagram describing the <u>pollution control facility</u> . Include a listing of each major piece of equipment included in the claimed fair cash value for real property. Include an <u>average</u> analysis of the influent and effluent of the control facility stating the collection efficiency.		
	Sec. E	List air contaminants, or water pollution substances released as effluents to the manufacturing processes. List also the final disposal of any contaminants removed from the manufacturing processes. Item (1) - Refers to pollutants and contaminants removed from the process by the pollution control facility. Item (2) - Refers to water pollution but can apply to water-carried wastes from air pollution control facilities. Submit drawings, which clearly show (a) Point(s) of discharge to receiving stream, and (b) Sewers and process piping to and from the control facility. Item (3) - If the collected contaminants are disposed of other than as wastes, state the disposition of the materials, and the value in dollars reclaimed by sale or reuse of the collected substances. State the cost of reclamation and related expense. Item (4) - State the date which the pollution control facility was first placed in service and operated. If not, explain. Item (5) - This information is essential to the certification and assessment actions. This accounting data must be completed to activate project review prior to certification by this Agency.		
	Sec. F	Self-explanatory. Signature must be a corporate authorized signature.		
	Submit to:	Attention:	Attention:	
	Illinois EPA P.O. Box 19276 Springfield, IL 62794-9276	Al Keller Permit Section Division of Water Pollution Control	Donald E. Sutton Permit Section Division of Air Pollution Control	

- Pit and Pit Pump-Cuts are Concrete Construction

Pit Depth = 8 feet

281'-4"

71'-2"

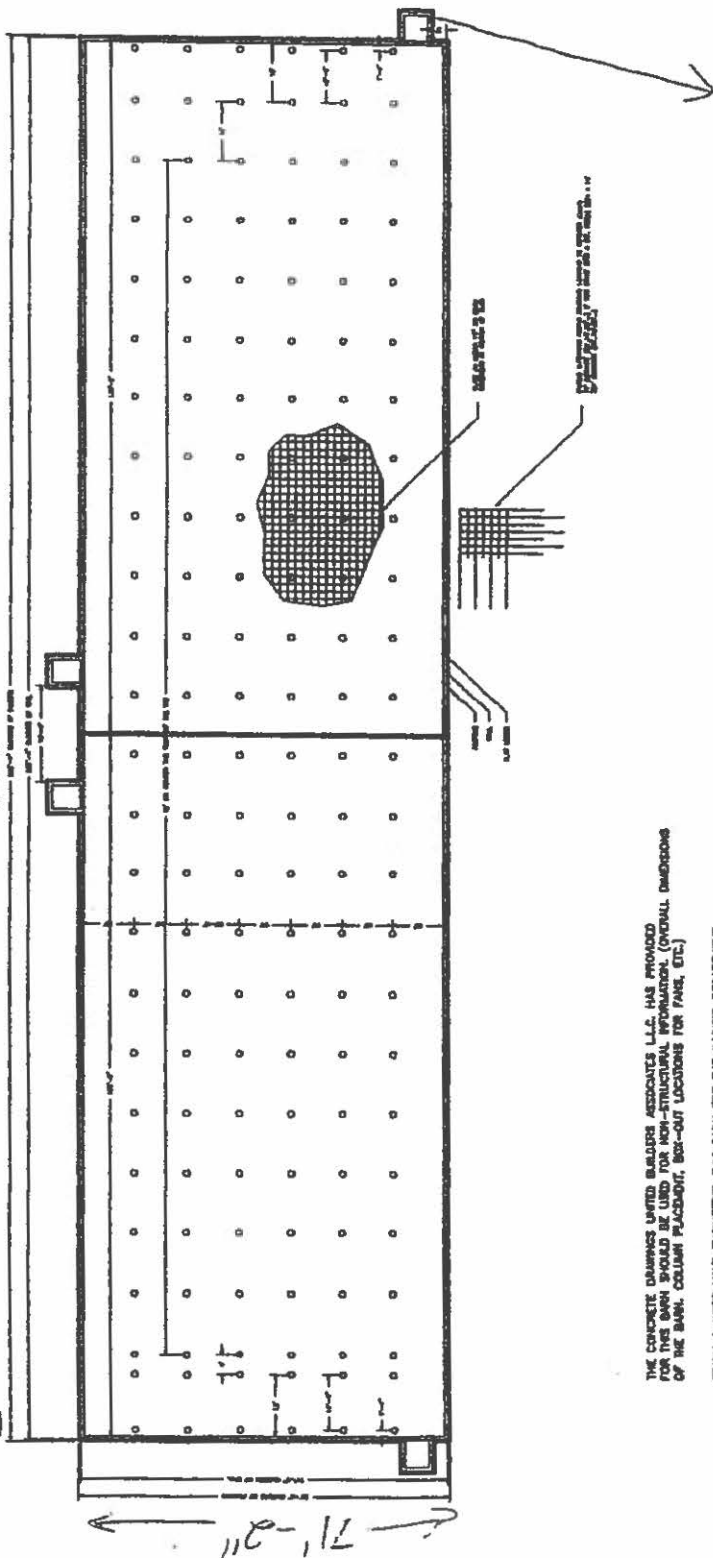

- Pit Pump-Cut Dimensions  
6' wide x 8' High

- 4 Pit Pump-Cut locations

THE CONCRETE DRAWINGS UNITED BUILDERS ASSOCIATES L.L.C. HAS PROVIDED FOR THIS BARN SHOULD BE USED FOR NON-STRUCTURAL INFORMATION. (SMALL DIMENSIONS OF THE BARN, COLUMN PLACEMENT, BOG-OUT LOCATIONS FOR PANS, ETC.)

FRANK & WEST HAVE ENGINEERED THIS BARN FOR THE ILLINOIS DEPARTMENT OF AGRICULTURE AND THEIR DRAWINGS SHOULD BE USED FOR THE STRUCTURAL INTEGRITY OF THE BARN. (BARN SPACING, SIZE OF REBAR, FOOTING DEPTH, WALL THICKNESS, ETC.)

<p>THESE DRAWINGS ARE THE PROPERTY OF FRANK &amp; WEST ENGINEERS ARCHITECTS INC. UNLESS SPECIFIED TO THE CONTRARY AND CANNOT BE REPRODUCED OR TRANSMITTED IN ANY FORM OR BY ANY MEANS, ELECTRONIC OR MECHANICAL, INCLUDING PHOTOCOPYING, RECORDING, OR BY ANY INFORMATION STORAGE AND RETRIEVAL SYSTEM, WITHOUT THE WRITTEN PERMISSION OF FRANK &amp; WEST ENGINEERS ARCHITECTS INC.</p>	<p>UNITS: ONLY DIMENSIONS - DIMENSION A</p> <p>DATE: 09/11/2015</p> <p>PROJECT: 16-048</p> <p>SCALE: 1/8" = 1'-0"</p> <p>DATE: 09/11/2015</p> <p>PROJECT: 16-048</p> <p>SCALE: 1/8" = 1'-0"</p>
--	---

# STRONGHURST

## T.9N.-R.5W.

SEE PAGE 66

*Barn location*

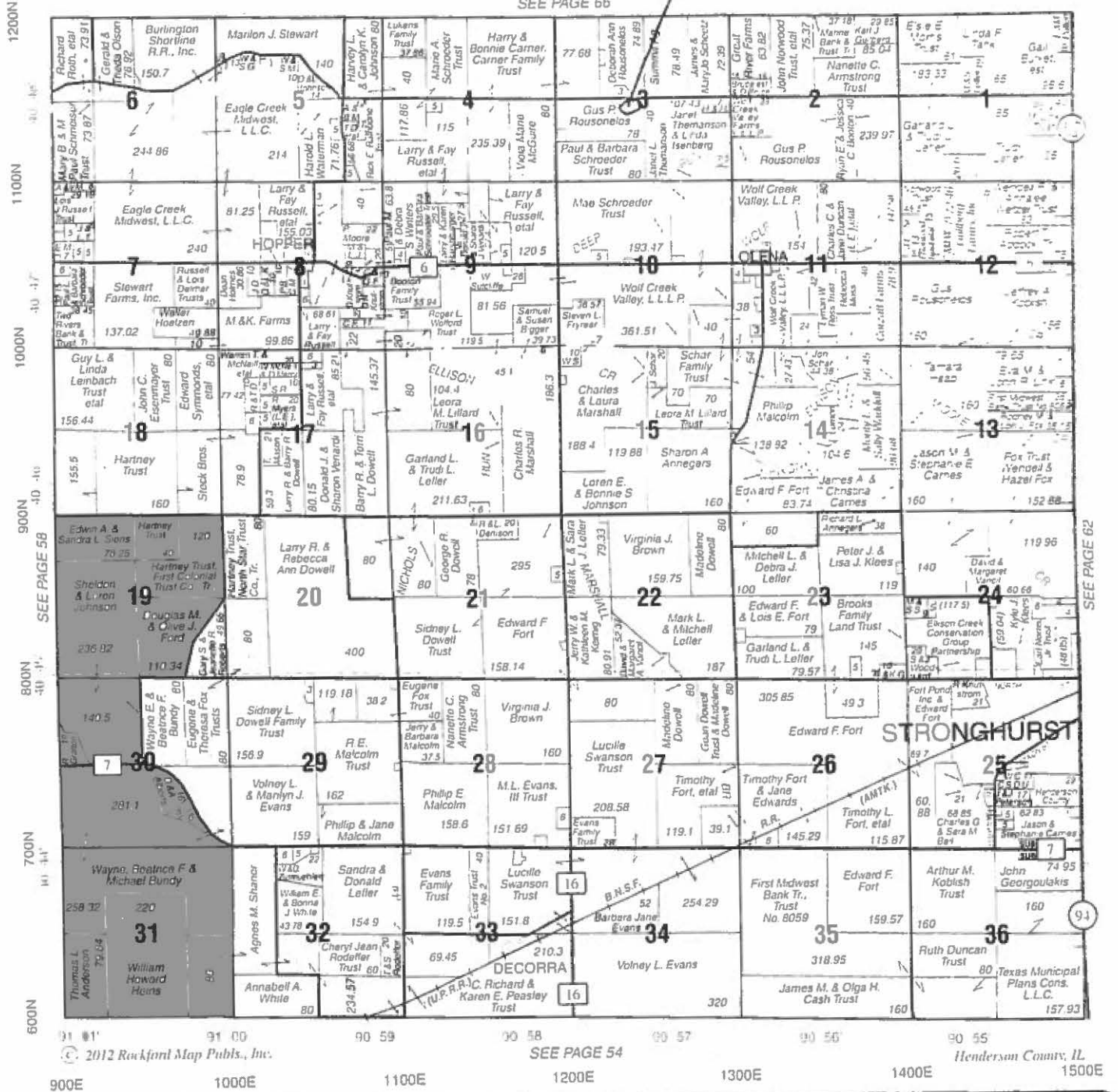

# Stronghurst Grain & Merchandise Company

P.O. Box 207  
 Stronghurst, IL 61480  
[www.stronghurstgrain.com](http://www.stronghurstgrain.com)

## Grain Drying & Storage

(309) 924-1271  
 Fax: (309) 924-1762

## Watershed Unit Tax Certification Review Sheet

---

Project Name: Lean Pork Producer, LLC

Location: Stronghurst

Reviewer: Jenny Larsen

Date: 03/15/2015

Log number: TC-03-15

Type:  Agchem  
 Livestock

Applicant:  
Gus P. Rousonelos  
25925 W. 135<sup>th</sup> St.  
Plainfield, IL 60544

Contact: Peter Rousonelos

Phone: (309)363-5358

Facility:  
Stronghurst, IL

Property ID: 08-003-004-00  
08-012-008-00

County: Henderson

Legal Description:  
S: 3 T: 9N R: 5W PM: 4<sup>th</sup>  
S: 12 T: 9N R: 5W PM: 4<sup>th</sup>

Signature: Gus Rousonelos

Title: Member

Date Control Devices installed: unknown

Provided Fair cash Value:  
500,000 for each site

Wastes:  Livestock waste is applied to cropland.  
 Agrichemical rinsate and spillage is recycled through the facility and/or land applied.  
 Other: \_\_\_\_\_

### Physical Description of Pollution Control Devices:

There are two facilities in this application both owned by Lean Pork Producer LLC. Each facility has a concrete manure pit to collect swine waste (281.33 ft. x 71.17 ft. x 8 ft. deep) with slotted floors to collect swine waste. Each manure pit has four (4) concrete pit pump outs (6 ft. x 6 ft. x 8 ft. deep). The manure is pumped out of the pits and applied to the fields as crop fertilizer.

The primary purpose for these structures is to contain swine manure thereby preventing contaminated water runoff.

Recommended Action: Permit the above mentioned structures.

APPLICATION FOR CERTIFICATION (PROPERTY TAX TREATMENT)  
 POLLUTION CONTROL FACILITY  
 AIR  WATER

ILLINOIS ENVIRONMENTAL PROTECTION AGENCY  
 P. O. Box 19276, Springfield, IL 62794-9276

This Agency is authorized to request this information under Illinois Revised Statutes, 1979, Chapter, 120, Section 502a-5. Disclosure of this information is voluntary. However, failure to comply could prevent your application from being processed or could result in denial of your application for certification.

FOR AGENCY USE			
File No.	Date Received	Certification No.	Date
Sec. A  APPLICANT	Company Name <i>Lean Pork Producer, LLC</i>		
	Person Authorized to Receive Certification <i>Gus P. Rousonelos</i>		Person to Contact for Additional Details <i>Peter Rousonelos</i>
	Street Address <i>25925 W. 135th St.</i>		Street Address <i>PO Box 211</i>
	Municipality, State & Zip Code <i>Plainfield, IL 60544</i>		Municipality, State & Zip Code <i>Stronghurst, IL 61480</i>
	Telephone Number <i>815-715-6494</i>		Telephone Number <i>309-363-5358</i>
	Location of Facility Quarter Section      Township      Range <i>SW Quarter Sec. 12-9N-5W</i>		Municipality      Township <i>Stronghurst</i>
	Street Address		County      Book Number <i>Henderson      548 page 201</i>
	Property Identification Number <i>08-012-008-00 / Facility ID # LFO710340000</i>		Parcel Number
	Sec. B  MANUFACTURING OPERATIONS	Nature of Operations Conducted at the Above Location  <i>Swine Production</i>	
Water Pollution Control Construction Permit No.		Date Issued	
NPDES PERMIT No.		Date Issued	Expiration Date
Air Pollution Control Construction Permit No.		Date Issued	
Air Pollution Control Operating Permit No.		Date Issued	
Sec. C  MANUFACTURING PROCESS	Describe Unit Process		
	Materials Used in Process		
Sec. D  POLLUTION CONTROL FACILITY DESCRIPTION	Describe Pollution Abatement Control Facility - Diagram Attached to Application - Dimension of Pit = 28' x 4" by 71'-2" by 8' deep - Dimension of Pit Pump Outs = 6' x 6' x 8' deep (4 total) - All concrete construction		

**RECEIVED**  
 JAN 27 2015  
 I EPA  
 BOWMPC/PERMIT SECTION

Sec. E	(1) Nature of Contaminants or Pollutants		
CONTAMINANTS		Material Retained, Captured or Recovered	
	Contaminant or Pollutant	DESCRIPTION	DISPOSAL OR USE
	Swine Manure	Swine Manure	Land Applied
POLLUTION CONTROL FACILITY - ACCOUNTING DATA	(2) Point(s) of Waste Water Discharge		
	none		
	Plans and Specifications Attached		Yes <input type="checkbox"/> No <input type="checkbox"/>
	(3) Are contaminants (or residues) collected by the control facility?		Yes <input type="checkbox"/> No <input type="checkbox"/>
	(4) Date installation completed	status of installation on date of application <u>Complete</u>	
	(5) a. FAIR CASH VALUE IF CONSIDERED REAL PROPERTY:	\$ <u>500,000</u>	
	b. NET SALVAGE VALUE IF CONSIDERED REAL PROPERTY:	\$	
	c. PRODUCTIVE GROSS ANNUAL INCOME OF CONTROL FACILITY:	\$	
	d. PRODUCTIVE NET ANNUAL INCOME OF CONTROL FACILITY:	\$	
	e. PERCENTAGE CONTROL FACILITY BEARS TO WHOLE FACILITY VALUE:	% <u>55%</u>	
Sec. F	The following information is submitted in accordance with the Illinois Property Tax Code, as amended, and to the best of my knowledge, is true and correct. The facilities claimed herein are "pollution control facilities" as defined in Section 11-10 of the Illinois Property Tax Code		
SIGNATURE			
	Signature	<u>Member</u> Title	
Sec. G	INSTRUCTIONS FOR COMPILING AND FILING APPLICATION		
	General: Separate applications must be completed for each control facility claimed. Do not mix types (water and air). Where both air and water operations are related, file two applications. If attachments are needed, record them consecutively on an index sheet.		
INSTRUCTIONS	Sec. A	Information refers to applicant as listed in the tax records and the person to be contacted for further details or for inspection of facilities. Define facility location by street address or legal description. A plat map location is required for facilities located outside of municipal boundaries. The property identification number is required.	
	Sec. B	Self-explanatory. Submit copies of all permits issued by local pollution control agencies. (e.g. MSD Construction Permit)	
	Sec. C	Refers to manufacturing processes or materials on which pollution control facility is used.	
	Sec. D	Narrative description of the pollution control facility, indicating that its primary purpose is to eliminate, prevent or reduce pollution. State the type of control facility. State permit number, date, and agency issuing permit. A narrative description and a process flow diagram describing the <u>pollution control facility</u> . Include a listing of each major piece of equipment included in the claimed fair cash value for real property. Include an <u>average</u> analysis of the influent and effluent of the control facility stating the collection efficiency.	
	Sec. E	List air contaminants, or water pollution substances released as effluents to the manufacturing processes. List also the final disposal of any contaminants removed from the manufacturing processes. Item (1) - Refers to pollutants and contaminants removed from the process by the pollution control facility. Item (2) - Refers to water pollution but can apply to water-carried wastes from air pollution control facilities. Submit drawings, which clearly show (a) Point(s) of discharge to receiving stream, and (b) Sewers and process piping to and from the control facility. Item (3) - If the collected contaminants are disposed of other than as wastes, state the disposition of the materials, and the value in dollars reclaimed by sale or reuse of the collected substances. State the cost of reclamation and related expense. Item (4) - State the date which the pollution control facility was first placed in service and operated. If not, explain. Item (5) - This information is essential to the certification and assessment actions. This accounting data must be completed to activate project review prior to certification by this Agency.	
	Sec. F	Self-explanatory. Signature must be a corporate authorized signature.	
	Submit to:	Attention: Al Keller Permit Section Division of Water Pollution Control	Attention: Donald E. Sutton Permit Section Division of Air Pollution Control
	Illinois EPA P.O. Box 19276 Springfield, IL 62794-9276		

- Pit and Pit Pump Cuts are Concrete Construction

Pit Depth = 8 feet

281'-4"

71'-2"

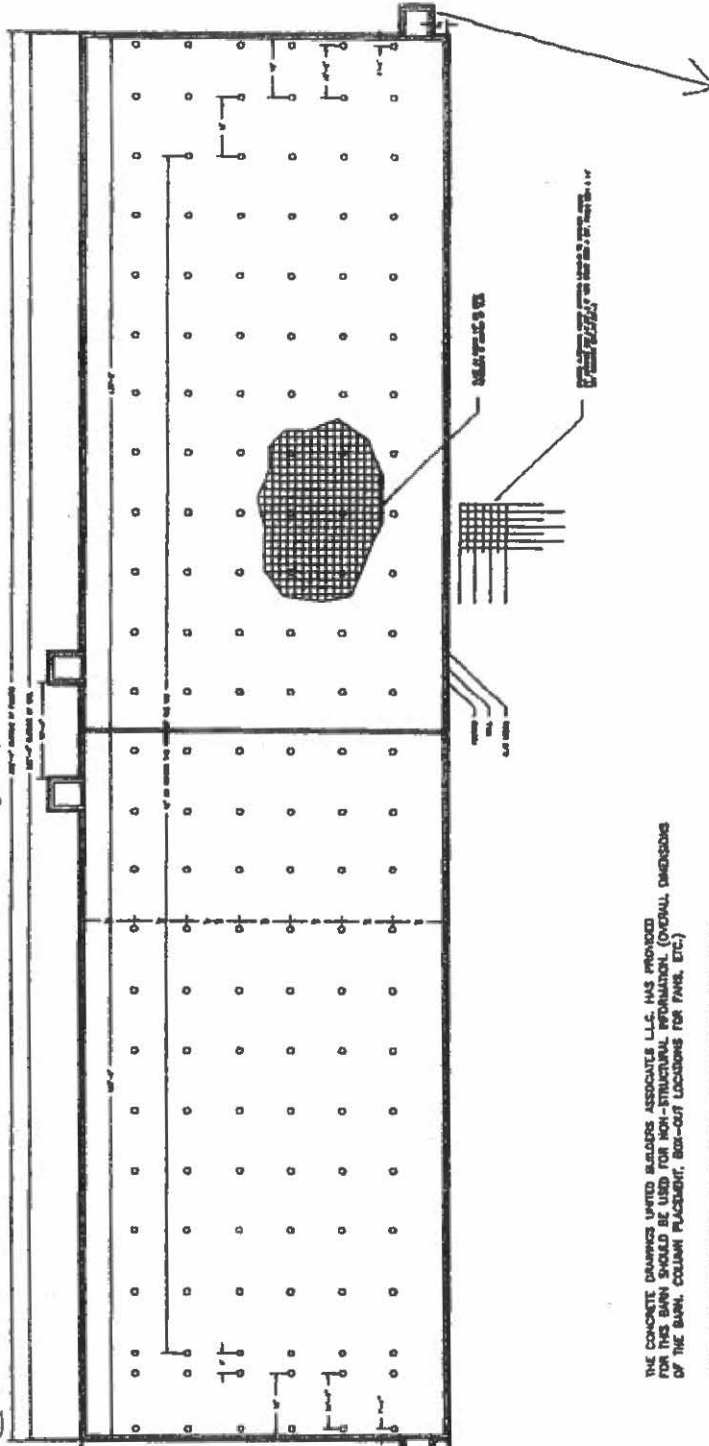

- Pit Pump-Cut Dimensions  
6' wide x 8' High  
- 4 Pit Pump-Cuts  
Locations

THE CONCRETE DRAWINGS UNITED ENGINEERS ASSOCIATES L.L.C. HAS PROVIDED FOR THIS BARN SHOULD BE USED FOR NON-STRUCTURAL INFORMATION. (ORIGINAL DIMENSIONS OF THE BARN, COLUMN PLACEMENT, BOX-OUT LOCATIONS FOR PANELS, ETC.)  
FRAM & MEET HAVE ENGINEERED THIS BARN FOR THE JUNIOR DEPARTMENT OF AGRICULTURE AND THEIR DRAWINGS SHOULD BE USED FOR THE STRUCTURAL INTEGRITY OF THE BARN. (REBAR SPACING, SIZE OF REBAR, FOOTING DEPTH, WALL THICKNESS, ETC.)

THESE DRAWINGS ARE THE PROPERTY OF UNITED ENGINEERS ASSOCIATES L.L.C. UNAUTHORIZED USE OF THE DRAWINGS PRESENTED HERE IS STRICTLY PROHIBITED

UNITED ENGINEERS ASSOCIATES L.L.C.  
1000 W. 10TH ST.  
MUSKOGEE, OK 74403  
PHONE (918) 683-3363  
FAX (918) 683-3363

DESIGN ONLY RESPONSIBILITY - CONCRETE A  
DRAWN BY: JAMES L. BRYAN  
DATE: 08/11/15  
SCALE: AS SHOWN  
SHEET NO. 1 OF 1  
JOB NO. 15-001

Burn location

# STRONGHURST

## T.9N.-R.5W.

SEE PAGE 66

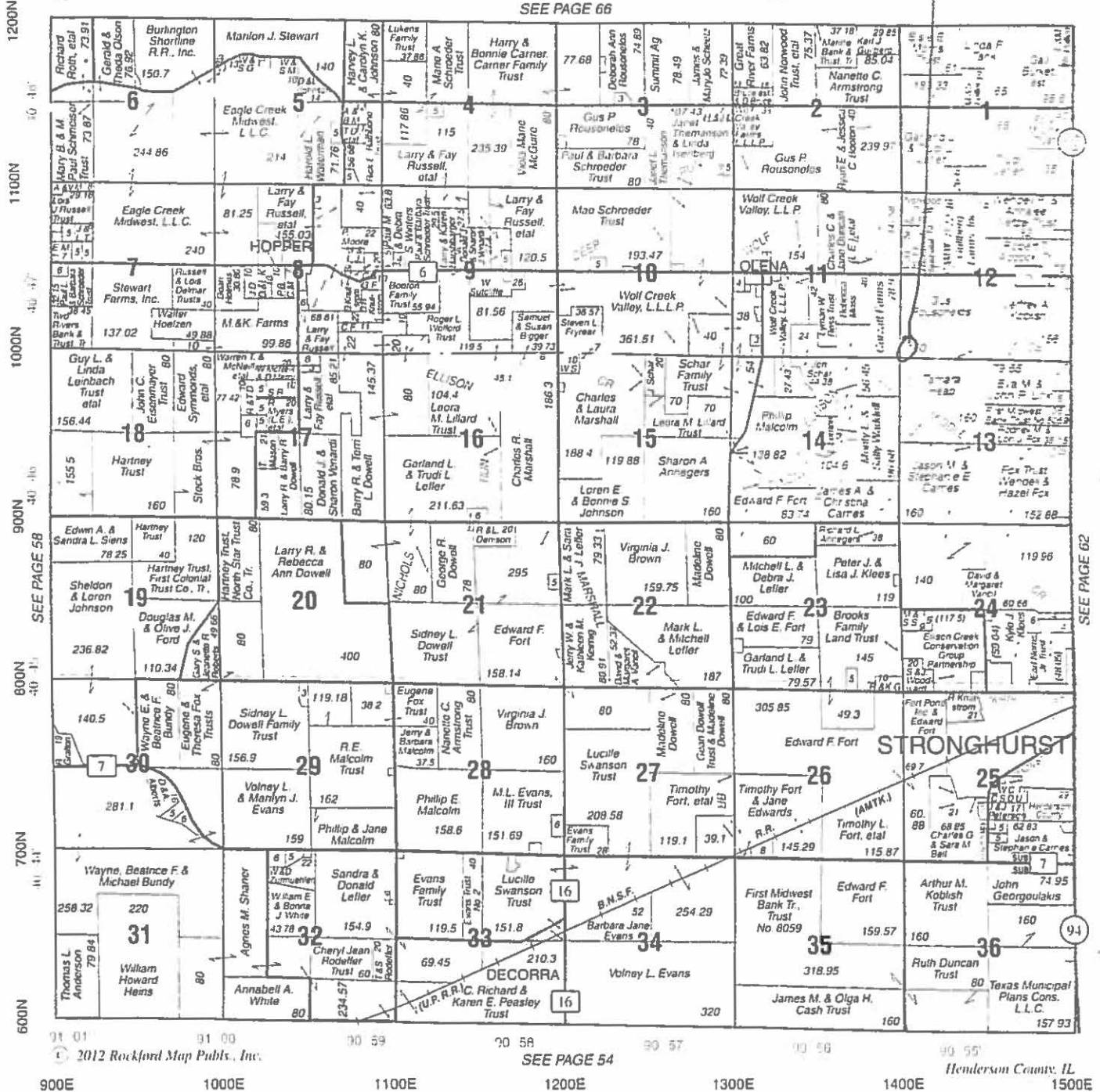

© 2012 Rockford Map Pubs., Inc.

SEE PAGE 54

Henderson County, IL

900E 1000E 1100E 1200E 1300E 1400E 1500E

# Stronghurst Grain & Merchandise Company

P.O. Box 207  
 Stronghurst, IL 61480  
[www.stronghurstgrain.com](http://www.stronghurstgrain.com)

## Grain Drying & Storage

(309) 924-1271  
 Fax: (309) 924-1762



STATE OF ILLINOIS )  
 )  
 )  
COUNTY OF SANGAMON )  
 )

**PROOF OF SERVICE**

I, the undersigned attorney at law, hereby certify that on September 11, 2015, I served true and correct copies of an **APPEARANCE AND THE RECOMMENDATION**, upon the persons and by the methods as follows:

**[1<sup>st</sup> Class U.S. Mail]**

Steve Santarelli  
Illinois Department of Revenue  
101 West Jefferson  
P.O. Box 19033  
Springfield, Illinois 62794

**[1<sup>st</sup> Class U.S. Mail]**

Peter Rousonelos  
P.O. Box 211  
Stronghurst, Illinois 61480

**[Electronic Filing]**

Clerk  
Illinois Pollution Control Board  
James R. Thompson Center  
100 West Randolph Street, Suite. 11-500  
Chicago, Illinois 60601

ILLINOIS ENVIRONMENTAL PROTECTION AGENCY

/s/ Joey Logan-Pugh  
Assistant Counsel  
Division of Legal Counsel  
1021 North Grand Avenue East  
P.O. Box 19276-  
Springfield, Illinois 62794-9276  
217.782.5544  
217.782.9143 (TDD)

**THIS FILING IS SUBMITTED ON RECYCLED PAPER**